

## RMK-9 – Keypad mat and UniControl fitting and removal

### Introduction

Due to the enhancement of the UniControl on the RMK-9 keypad the fitting and removal instructions detailed in this document should be followed. This document supersedes the keypad fitting and removal instructions contained in the RMK-9 installation instructions manual.

### Fitting the keypad mat

Your keypad is supplied with a portrait and a landscape keypad mat.

You should fit the keypad mat which matches your chosen mounting orientation.

1. Ensure the keypad mat is orientated correctly.
2. Fit the keypad mat into the keypad so that the keypad mat tabs slide into the holes in the keypad, as shown below.

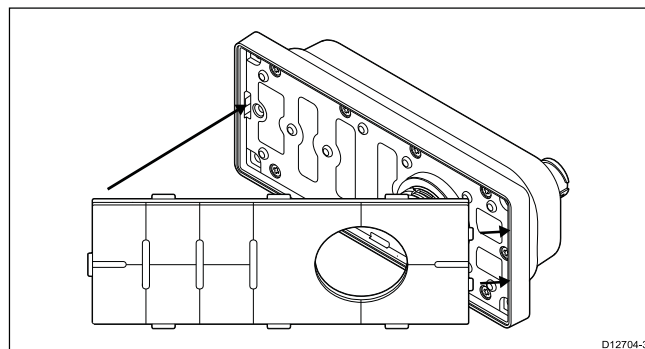

3. Close the opposite end of the keypad mat into the keypad ensuring that the end tab and all side tabs (shown below) click firmly into place.

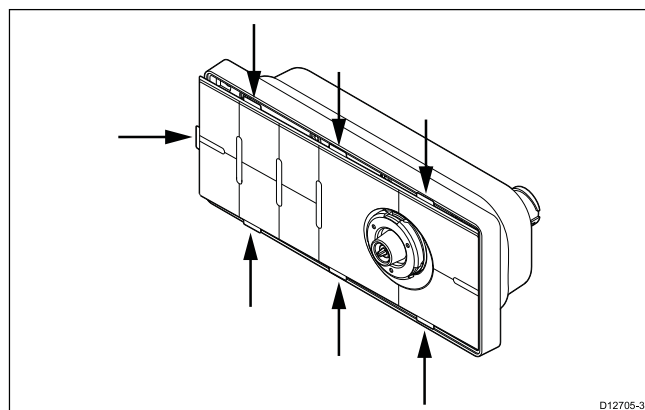

Document number: 82302-2

Date: 10-2013

### Fitting the UniControl

Once the keypad mat has been fitted the UniControl must be fitted as described below.

1. Place the Joystick insert of the UniControl over the joystick spline on the keypad

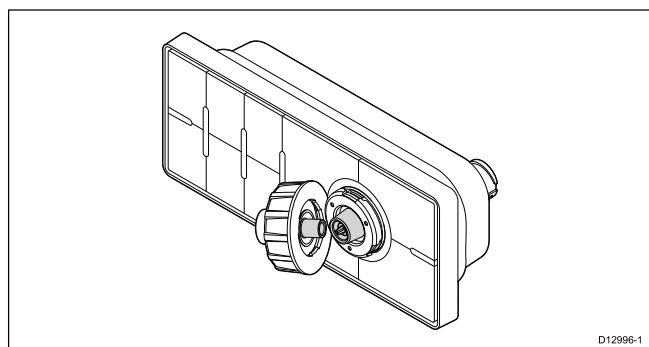

2. Align the 3 locating tabs on the reverse of the UniControl to the 3 guides on the keypad.
3. Push the UniControl towards the keypad at a point approximately in the middle of 2 of the tabs.

This should engage the first 2 tabs.

4. Push the UniControl towards the keypad at the location of the third tab.

You should hear a click to signify that the UniControl is now seated correctly.

5. Ensure that the UniControl is seated evenly all the way around.

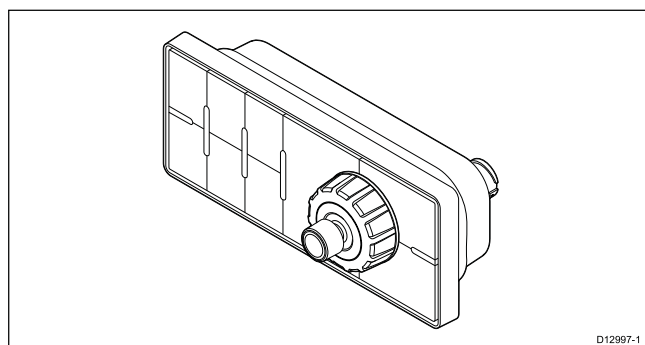

## Removing the UniControl

To remove the UniControl from the keypad follow the steps below.

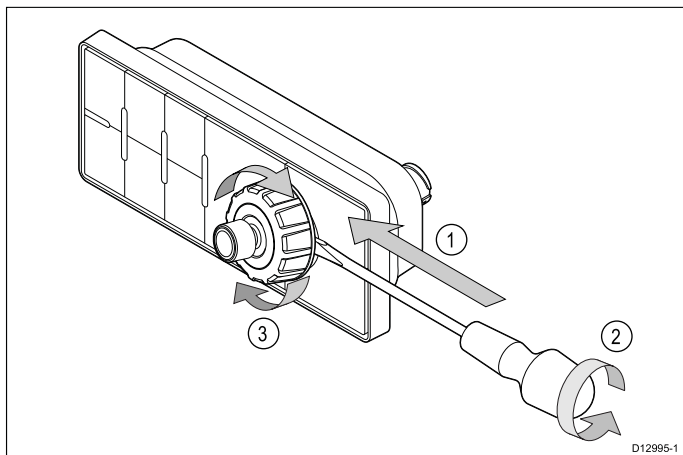

1. Slide a small flat bladed screwdriver between the UniControl and the keypad.
2. Twist the screwdriver to lever the UniControl away from the keypad.
3. Rotate the UniControl approximately quarter of a turn.
4. Repeat steps 1 to 3 above until the UniControl comes free from the keypad.

## Removing the keypad mat

The keypad mat can be removed from the keypad following the steps below.

RMK-9 – Keypad mat and UniControl fitting and removal

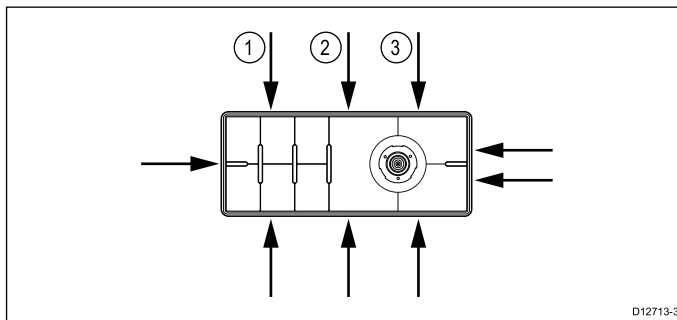

Locking tabs are located at the positions shown above.

**Note:** Take care and ensure the keypad housing is not damaged

1. Using a thin bladed screwdriver insert the tip of the screwdriver into the recess between the edge of the keypad mat and the keypad housing at location (1) shown above.
2. Gently push the screwdriver away and down from the keypad mat to release the keypad mat tabs.
3. Repeat steps 1 and 2 for tabs at locations (2) and (3).
4. With all 3 tabs along one side of the keypad free the keypad mat should easily come away from the keypad.