

SEAVIEW///

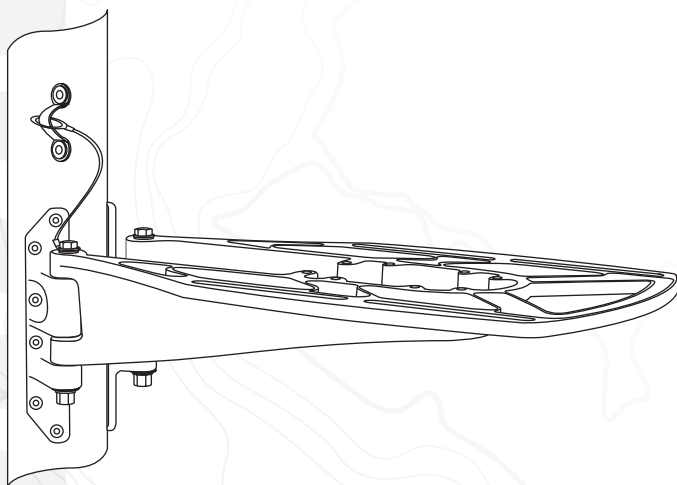

INSTALLATION INSTRUCTIONS

For Seaview Mast Mount:

SM-18-R

Refer to website for most up to
date instructions and videos.

WWW.SEAVIEWGLOBAL.COM

PARTS INCLUDED

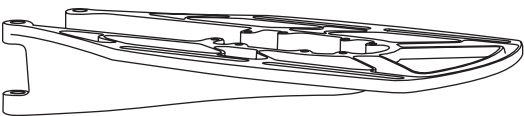

X1

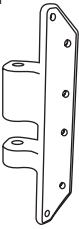

SMMBR-2

x1

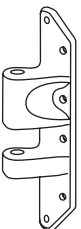

SMMBL-2

x1

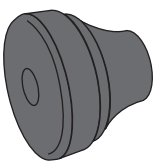

X1

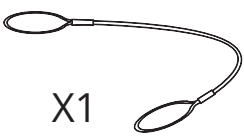

X1



X1



X14



X2



X2



X2



X3

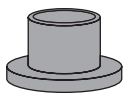

X12

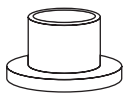

X4

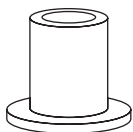

X10

TOOLS NEEDED



Sudbury Elastomeric Marine Sealant is recommended. To purchase call 800-655-7922 or visit www.seaviewglobal.com



Tef-Gel or Equivalent

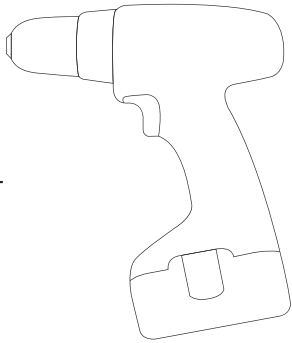

Sharpened dowel pin

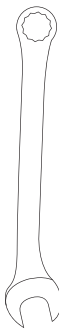

5/16" = 8mm



3/16" = 4.7mm

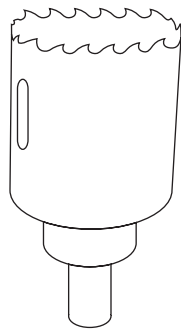
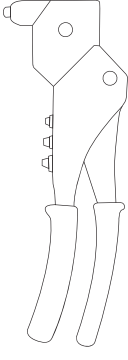
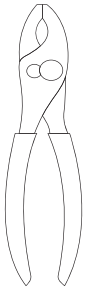

15/16" = 25mm

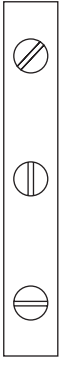

1

SM-18-R Mast Mount foot assembly.

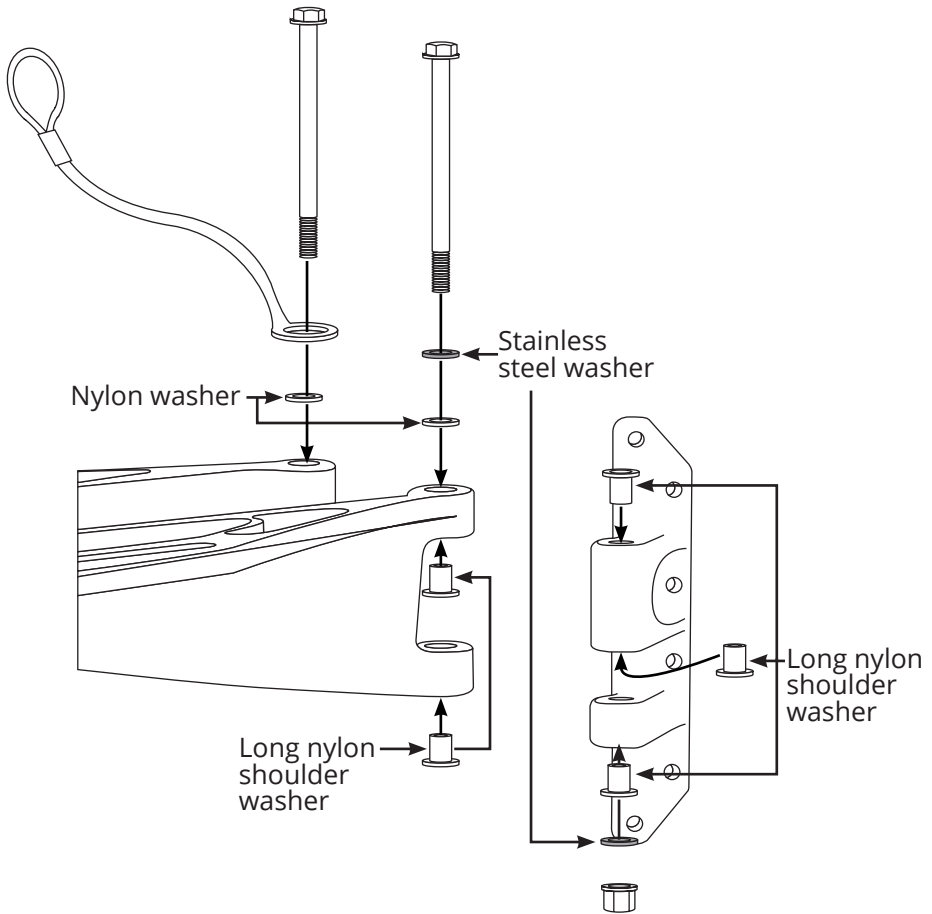

2

Please note that when installing the Seaview Mast Mount, have it facing the forward end of the boat.

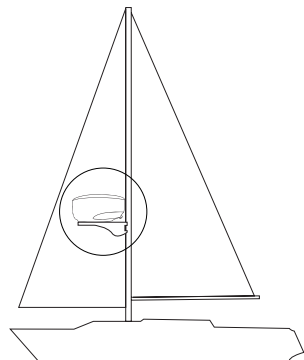

3

If installing on a isomat mast you will need a Seaview isomat adapter. Part number SM-AD-ISO.

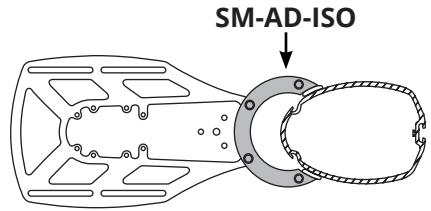
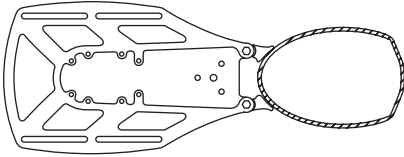

4

Place the SM-18-R onto the mast and mark all the holes of each mounting feet. Be sure that the mast mount is level. If the mast mount feet are not assembled refer to the diagram step 16.

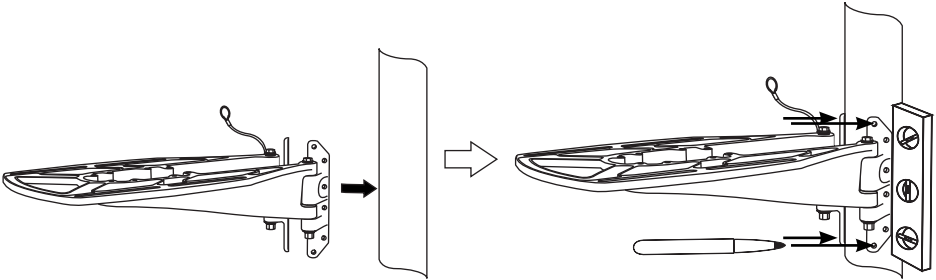

5

Using a 3/16" drill bit, drill all the marked holes.

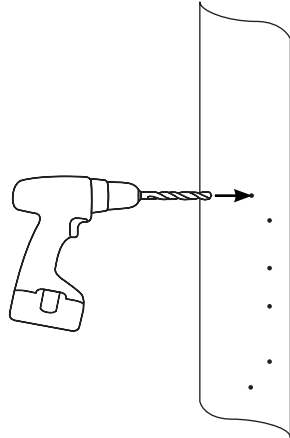

6 Use a hole saw to drill a hole for the cables. Be sure to drill in the center of the mast.

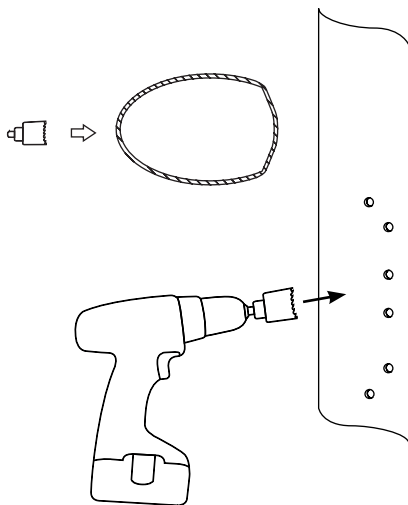

7 Punch a hole through the rubber grommet using a sharp dowel.

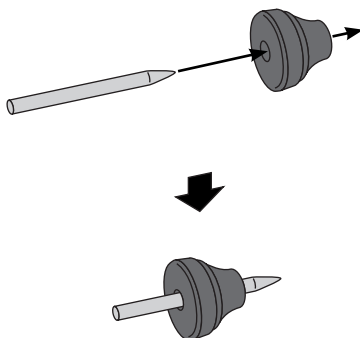

8 Insert the rubber grommet into the hole you drilled for the cables.

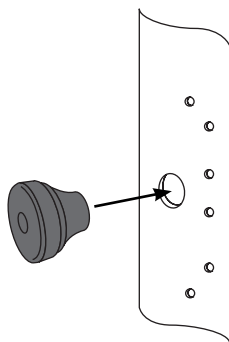

9

Put some Tef-Gel into the holes. Do not apply too much.

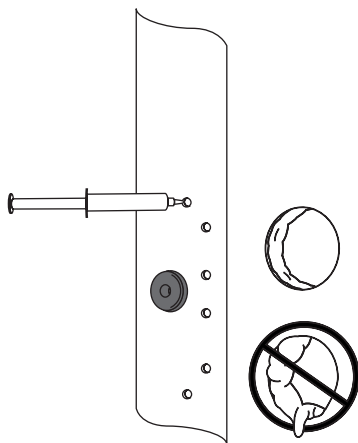

10

Insert the black nylon shoulder washers into the correct holes on the mast mount feet. Use the supplied rivets to secure the mast mount to the mast.

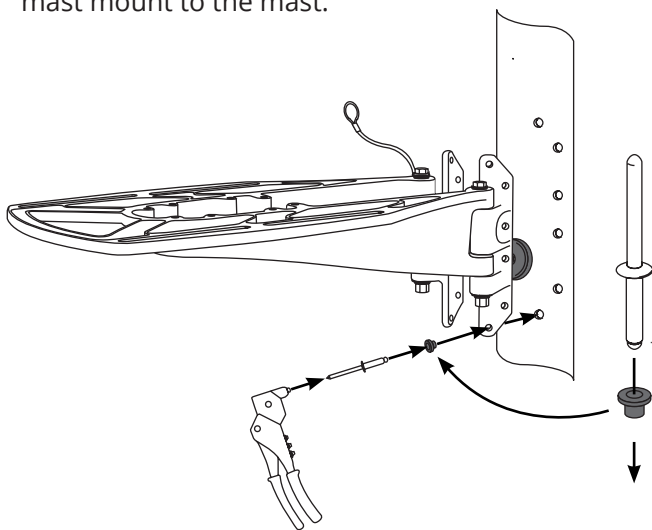

11

Mark two holes to fasten the anchor.

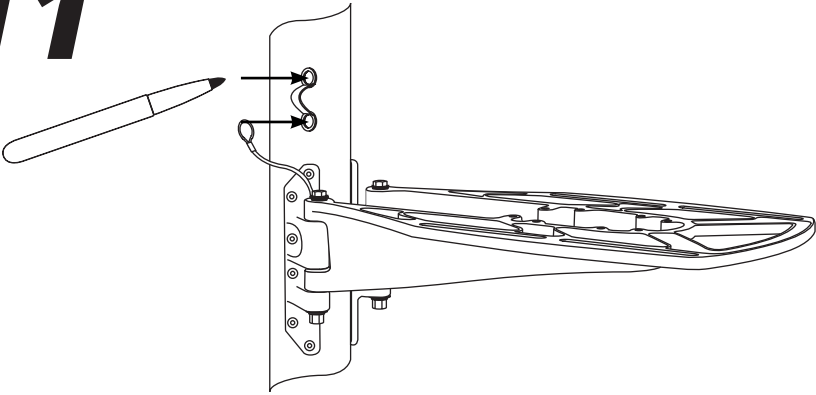

12

Drill the two holes.

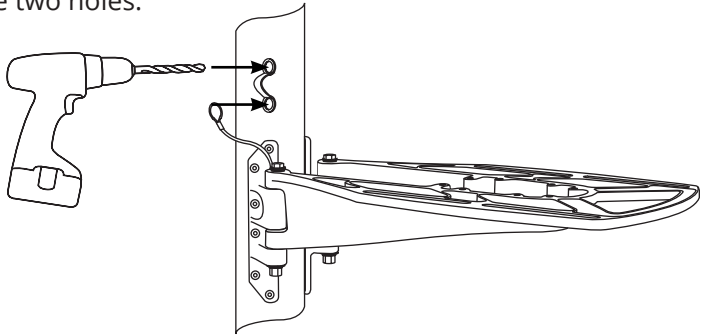

13

Apply Tef-Gel to the two holes.

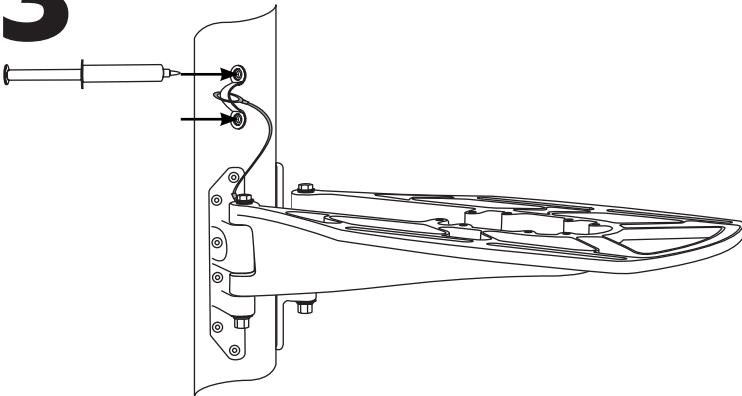

14

Secure the anchor to the mast using two rivets. Make sure the lanyard is on the anchor prior to securing rivets.

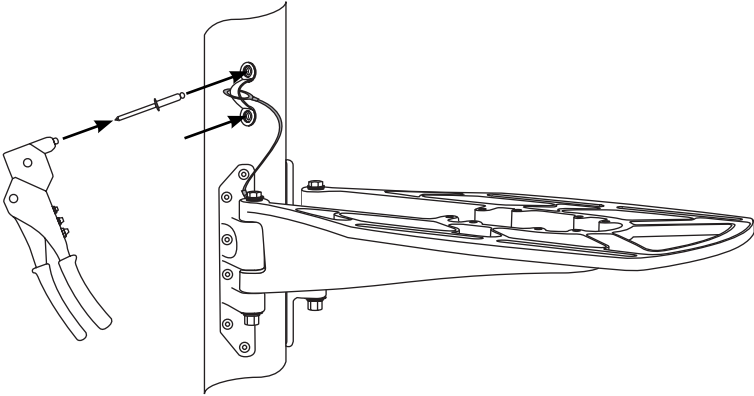

15

Insert four nylon shoulder washers to the rails of the mast mount.

Using your own hardware secure the radar to the mast mount.

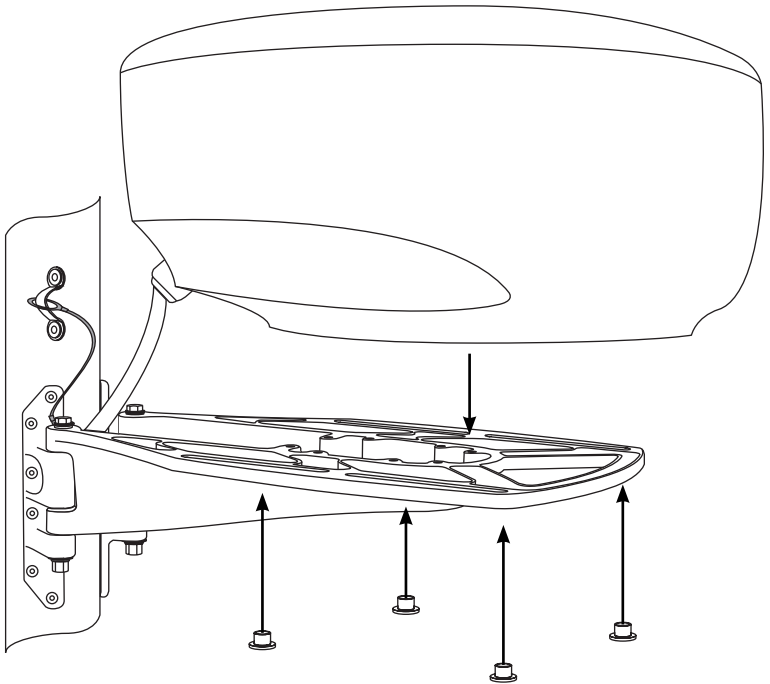

16

Mount the radar as close to the mast as possible.

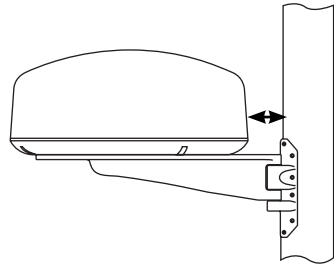
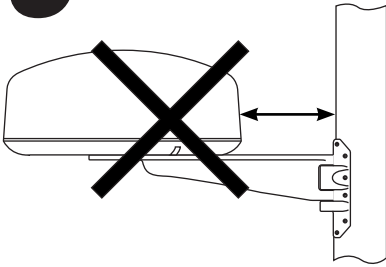

OPTIONAL ACCESSORIES

Call 800-655-7922 or visit www.seaviewglobal.com for available accessories.

SS MAST MOUNT GUARDS

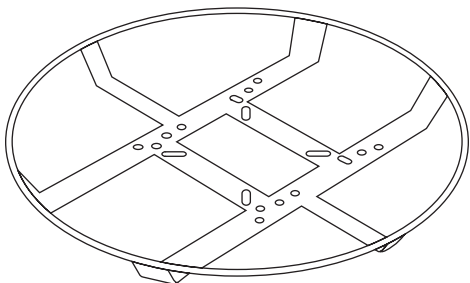

Protect your radome from damage and reduce wear and tear on the sails with Seaview Mast Mount Guards. Available for 18" - 24" closed dome radars.

ISOMAT ADAPTER

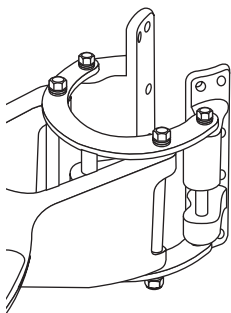

SM-AD-ISO

For masts with an integral track at the front which makes it difficult to fit a Seaview mast mount. Made from marine grade aluminum and powder coated brilliant white.

FLYBRIDGE ADAPTER

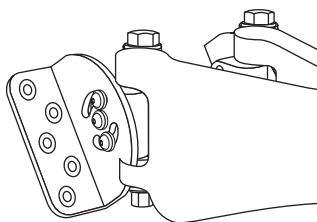

SM-AD-FB

Adjustable flybridge adapter kit with 35° of adjustment.

***THIS PAGE IS INTENTIONALLY
LEFT PLANK.***

The background of the entire page is a light gray topographic map with white contour lines. The lines are irregular and wavy, creating a sense of depth and movement. The map covers the entire page, with the text elements overlaid on it.

***SEAVIEW*///**

ELEVATE YOUR ELECTRONICS

***SEAVIEW*///**

Tel: 800-655-7922
www.seaviewglobal.com

EUROPEAN OFFICE

Tel: +33 4 94 53 27 70
www.seaviewprogress.com

4-102418